

CRUSHED STONE BASE SHALL BE IN ACCORDANCE WITH OHIO D.O.T. SPECIFICATION 304

TYPE "C"

BITUMINOUS CONCRETE SHALL BE IN ACCORDANCE WITH OHIO D.O.T. SPECIFICATION 448.

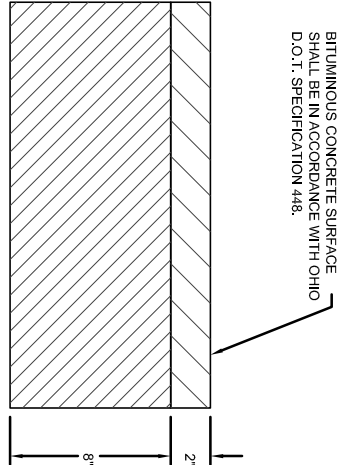

BITUMINOUS AGGREGATE BASE SHALL BE IN ACCORDANCE WITH OHIO D.O.T. SPECIFICATION 301.

TYPE "E"

BITUMINOUS CONCRETE SHALL BE IN ACCORDANCE WITH OHIO D.O.T. SPECIFICATION 448.

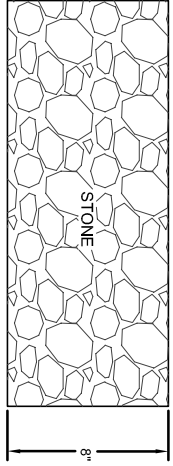

CRUSHED STONE BASE SHALL BE IN ACCORDANCE WITH OHIO D.O.T. SPECIFICATION 304

TYPE "D"

BITUMINOUS CONCRETE SURFACE SHALL BE IN ACCORDANCE WITH OHIO DEPT. OF TRANSPORTATION (D.O.T.) SPECIFICATION 448.

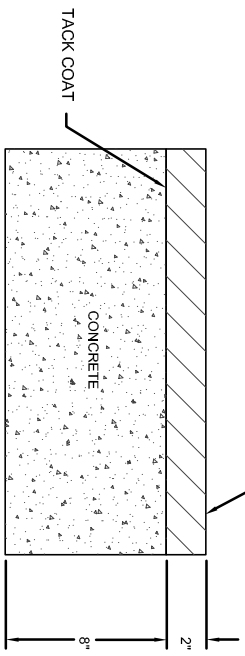

PORTLAND CEMENT CONCRETE BASE SHALL BE IN ACCORDANCE WITH OHIO D.O.T. SPECIFICATION 305.

TYPE "A"

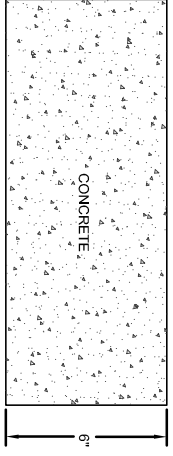

PORTLAND CEMENT CONCRETE BASE SHALL BE IN ACCORDANCE WITH OHIO D.O.T. SPECIFICATION 492.

TYPE "B"

**PAVEMENT REPLACEMENT
DETAILS**



BUTLER COUNTY
WATER AND SEWER
130 HIGH STREET
HAMILTON, OH 45011
TELEPHONE: 513-887-3066
FAX: 513-887-3777